

- FU-100-CL
- FU-200-CL
- FU-300-CL
- FU-400-CL
- FU-500-CL
- FU-100-DL
- FU-200-DL
- FU-300-DL
- FU-400-DL
- FU-500-DL

取扱説明書 User Manual

アステラテック株式会社
Astellatech, Inc.

2024-10-28

各部の名称

Names of Components

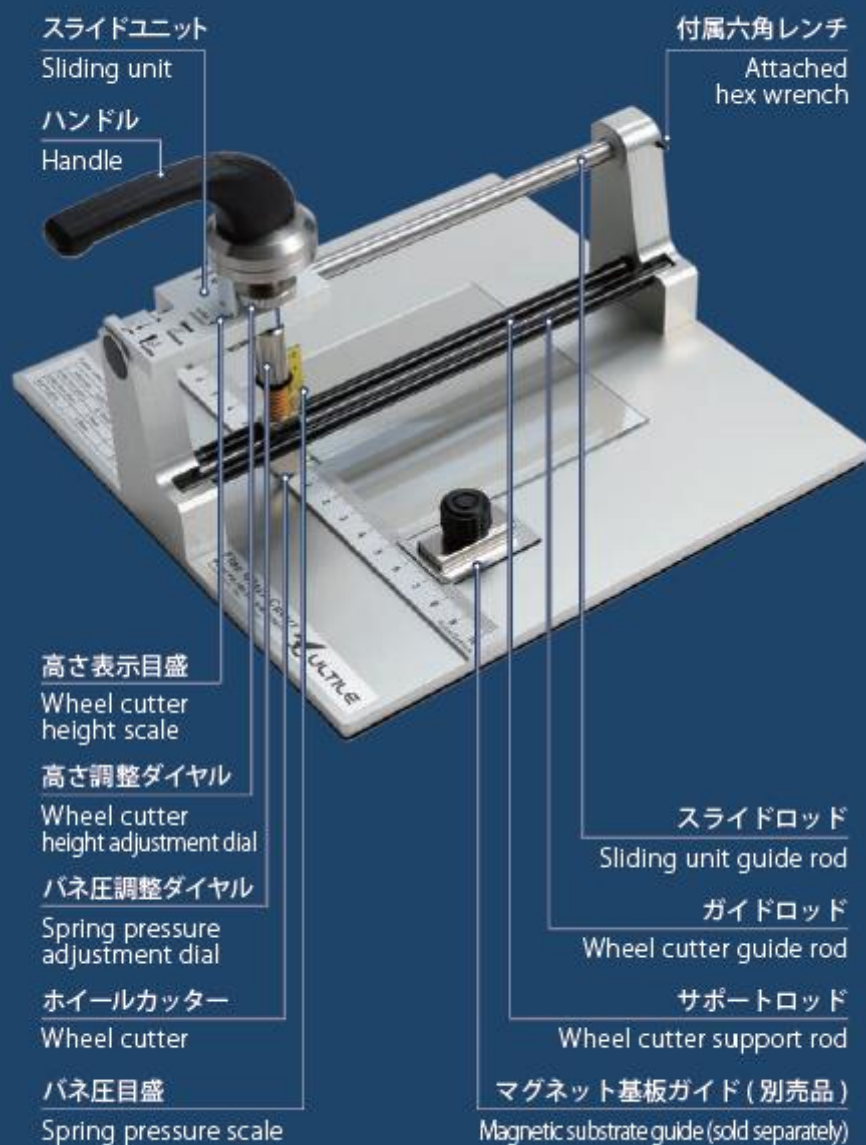

Cutting glass

1 Adjust the height of the wheel cutter

Tune the position of the wheel cutter by turning the wheel cutter height adjustment dial ①.

Check the position with the wheel cutter height scale ②.

The initial height is 0. By rotating the dial to the arrow direction ③ once, the height increases by 0.5mm.

Turn twice for a 1mm-thick substrate

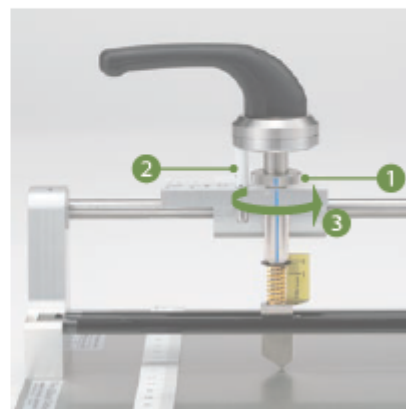

2 Tuning the pressure of the spring

Tune the pressure of the spring that pushes the wheel cutter by rotating the spring pressure adjustment dial ①.

Check the spring pressure scale ③ by the position of the black washer ②.

By rotating the dial to the arrow direction ④ once, the pressure increases by 5N.

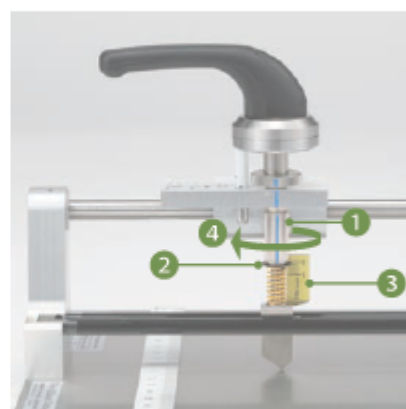

HINT

Refer to Typical cutter pressure table at the lower left of the plate for your cutter.

A single turn is enough for most of the other thicknesses of substrate

3 Placing the glass

Move the sliding unit ① to the starting point of scribing. The handle ② must be directing opposite to the starting point. The wheel cutter is able to cut the substrate with this handle direction.

Next, place the glass substrate correctly to the position to cut and hold it by your hand.

HINT

For precisely determining the cutting position, use of magnetic substrate guide ③ (sold separately) is recommended.

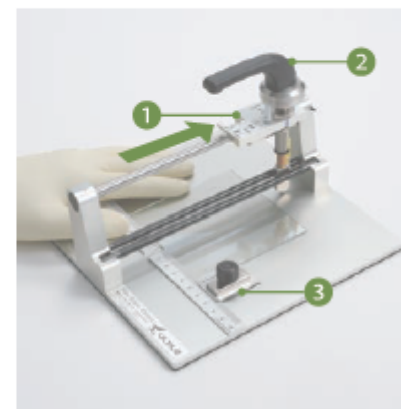

4 Scribing

Scribe the glass by pulling the handle ① slowly from the starting point to the end of the substrate. The faster the scribing, the shallower the fissures to be made. Always pull the handle. Do not press it from the top.

HINT

Fine tune the height by cutting an actual sample to find the best position of the cutter.

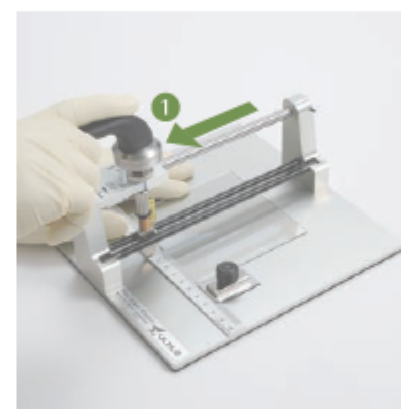

5 Splitting the glass

Carefully take the glass out. Hold the glass evenly at the right and left of the fissure with your fingers. Split the glass by applying force to the arrows directions ①.

HINT

If the depth of the fissure is not uniform throughout the substrate, apply force at the place where the fissure is deeper.

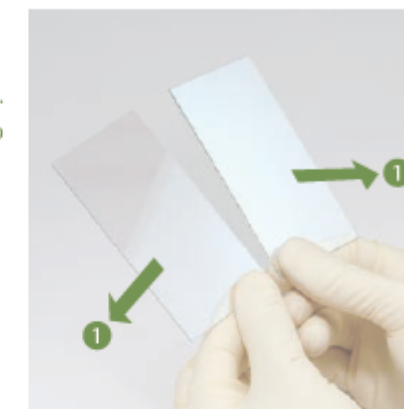

Scribing the same substrate successively

Temporarily turn the handle ① to the direction ② 90° from the scribing position.

The wheel cutter raises 0.7mm and the cutter becomes free to move. Move the wheel cutter to the initial position ③ of the glass cutting and then, rotate the handle to the cutting direction.

Move the glass, set it to the next position to scribe, and then scribe. Repeat the procedures to scribe several times on the same substrate.

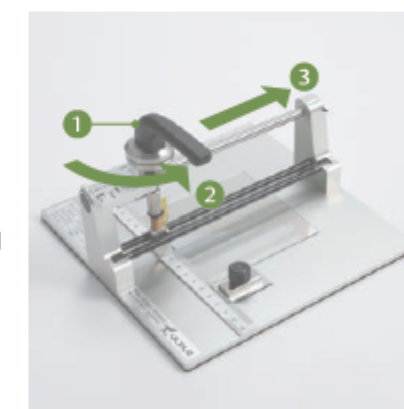

Replacing wheel cutter

1

Rotate the wheel cutter height adjustment dial ① and the spring pressure adjustment dial ② to the original point of 0.

By doing so, the blue lines of each adjustment dial and the slide unit ③ line straight.

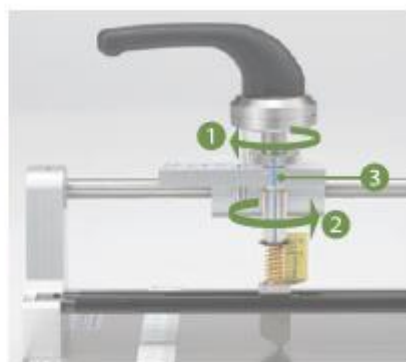

2

Move the slide unit to the wheel cutter replacement position (to the direction ①) and remove the wheel cutter guide rod ②.

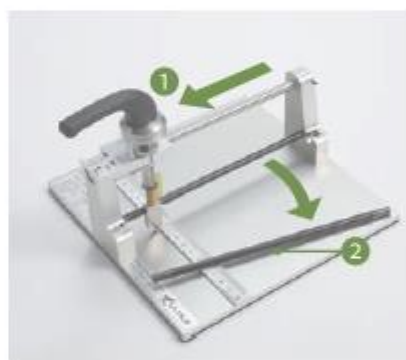

3

Turn the handle over 90° to the left ①.



4

Loosen the screw ② that fixes the wheel cutter using the attached hex wrench ① and remove the wheel cutter.

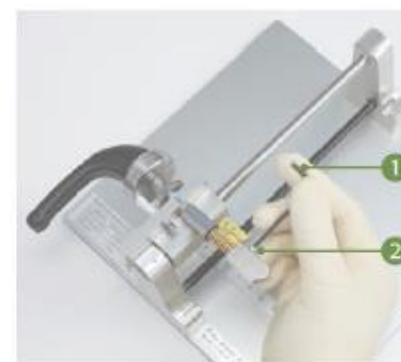

5

When inserting a new wheel cutter, hold the handle lightly not to let it stick out to the left. Attach the wheel cutter to the shaft. After positioning the wheel cutter correctly, tighten the screw using the attached hex wrench ①.



6

Return the handle to the scribing position and set the wheel cutter guide rod ①.



Precautions for use

- ⚠ Wheel cutters wear by use. Replace it when it becomes dull.
- ⚠ For the long use of this product, wipe the sliding unit guide rod periodically and put grease to replenish it in the slide unit.
- ⚠ Do not disassemble the product needlessly.

Visit our website for more information on Precision Glass Cutter.
Instruction movie is also available on this site.



https://www.astellatech.co.jp/glass_cutter/english.html

Contact us when you have inquiries or you want to place an order for the parts sold separately.
e-mail contact@astellatech.co.jp